

MAX. PRESSURE— 110" H<sub>2</sub>O (60Hz), 85" H<sub>2</sub>O (50Hz)  
 MAX. AIR FLOW— 265 CFM (60Hz), 225 CFM (50Hz)

MOTOR ENCLOSURE: TEFC

HP/kw: 60Hz 5.5/4.1  
 50Hz 5.0/3.7  
 VOLTAGE: 60Hz 208-230/460-3  
 50Hz 190-220/380-415-3  
 AMPS: 60Hz 19.5-18.2/9.1  
 50Hz 14.2-13.4/7.1  
 STARTING AMPS: 60Hz 83 @ 460V  
 50Hz 72 @ 380V

RECOMMENDED NEMA STARTER SIZE: 1/0  
 NET WEIGHT(lbs/kg): 215/98

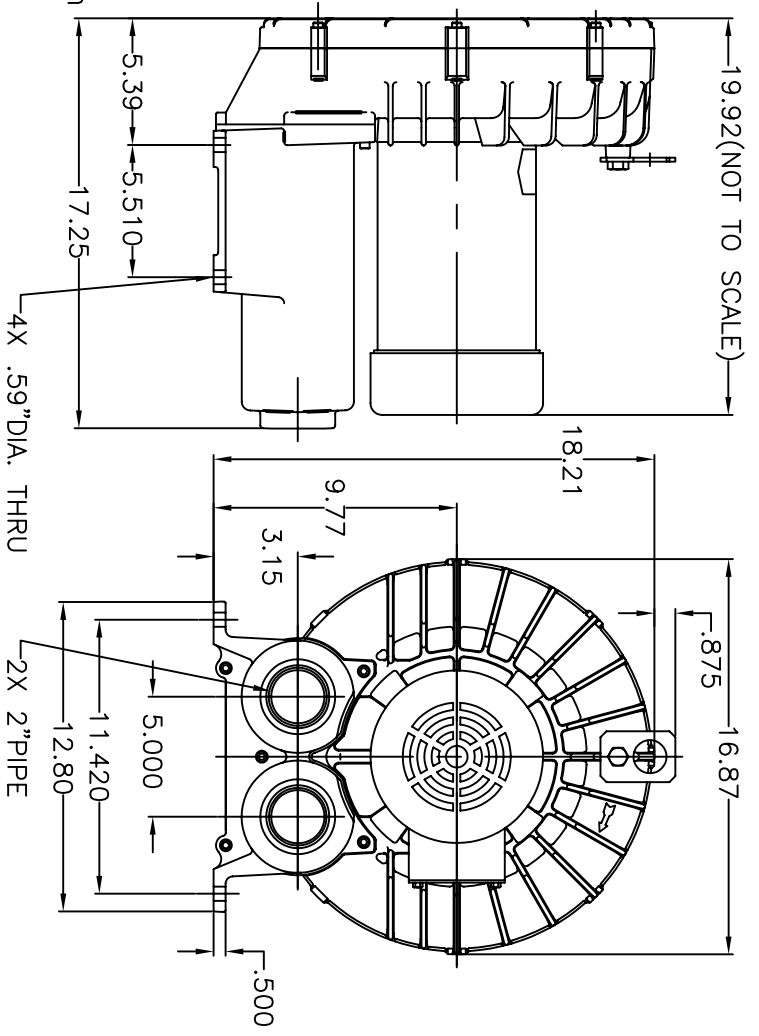

REV.	DATE	REVISION	BY
		FINISH REQUIRED	
TOLERANCES UNLESS OTHERWISE NOTED			
		±.005 .000	
		±.015 .00	
		FRACTIONAL	
		±1/64	
		ANGULAR	
		±1°	

**QAC** CONVERTER ACCESSORY CORP.  
 WIND GAP, PA

TITLE: MODEL #700G REGENERATIVE BLOWER  
 DRAWN BY: MJT SCALE: 1/8" = 1"  
 DATE: 1-24-05  
 DWG. NO.: 20222-58 DISK FILE: MEPROJ

CUSTOMER: \_\_\_\_\_  
 CUSTOMER SO#: \_\_\_\_\_ DATE: \_\_\_\_\_

THESE DRAWINGS AND SPECIFICATIONS CONTAIN INFORMATION PROPRIETARY AND CONFIDENTIAL. NO PORTION OF THIS DRAWING MAY BE REPRODUCED OR COPIED WITHOUT PRIOR WRITTEN PERMISSION OF CONVERTER ACCESSORY CORPORATION.