

OPTIONAL

- ☐ CORE STOP FLANGE
(VALVE END ONLY)
☐ NONE

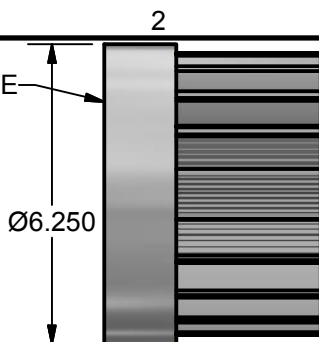

NOTE:

1) CHUCK INSIDE DIAMETER IS 4.00" STOCK.
INTERNAL BUSHINGS (EACH END)
ARE BORED TO FIT THRU SHAFT.

2)

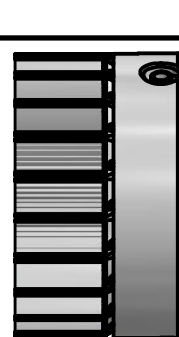

OPTIONAL VALVE LOCATION
(SEE INFLATING VALVE TYPE)

B

B

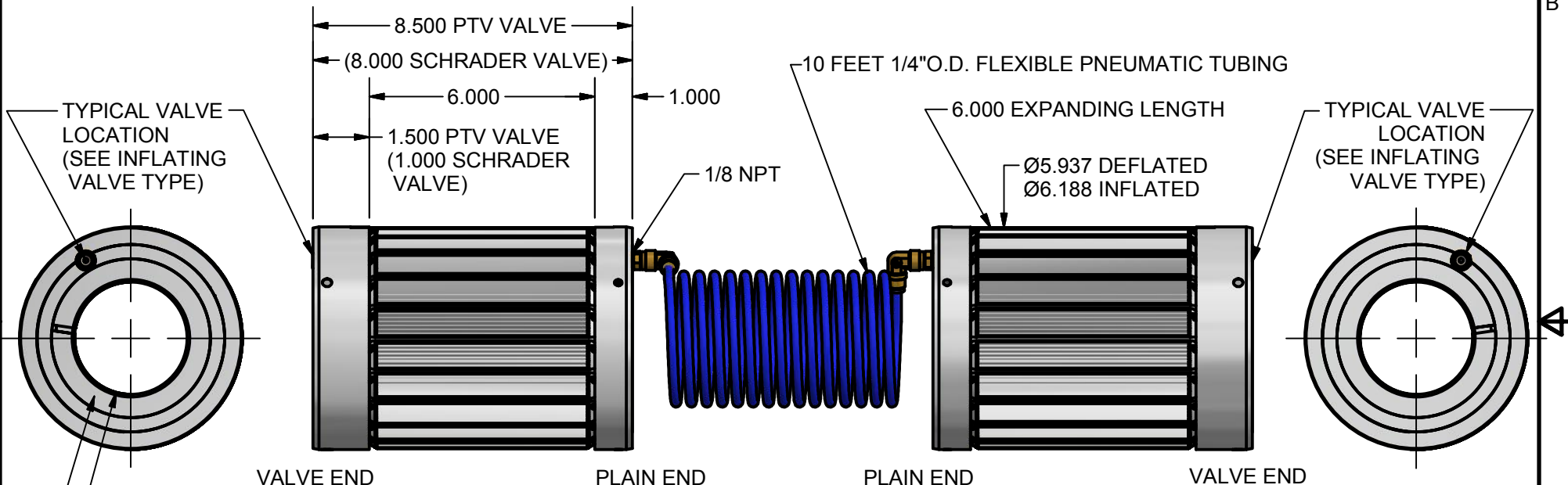

VALVE END

PLAIN END

PLAIN END

VALVE END

CUSTOMER: _____

APPROVED BY: _____

DATE: _____

OPERATING SPECIFICATIONS:

MACHINE: _____

MATERIAL: _____

THICKNESS: MIN. _____ MAX. _____

WIDTH: MIN. _____ MAX. _____

SPEED: MIN. _____ MAX. _____

TENSION: MIN. _____ MAX. _____

CORE DIA.: _____

CORE MATERIAL: _____

MAX. ROLL DIA.: _____

MAX. ROLL WEIGHT: _____

☐ UNWIND ☐ REWIND

☐ SINGLE WIDTH ☐ SLIT WIDTHS

INFLATING VALVE TYPE:

☐ PTV VALVE

☐ SCHRADER VALVE

☐ TYPICAL LOCATION ☐ OPTIONAL LOCATION

THESE DRAWINGS AND SPECIFICATIONS CONTAIN INFORMATION WHICH
CONVERTER ACCESSORY CORPORATION CONSIDERS PROPRIETARY AND CONFIDENTIAL.
NO PORTION OF THIS DRAWING MAY BE REPRODUCED OR COPIED WITHOUT PRIOR
WRITTEN PERMISSION OF CONVERTER ACCESSORY CORPORATION.



CONVERTER ACCESSORY CORP.

WIND GAP, PA 18091

WWW.CONVERTERACCESSORY.COM

TITLE

6 INCH TANDEM COR-LOK AIR CHUCKS

SIZE

A

DWG NO

18503-224

REV

DATE

DRAWN

FILE

MEMAST

QUOTE NO.

2

1