

MODEL NO.	CURVE NO.	FLOW (CFM)	MAX. PRESSURE (INCH WATER)	MAX. VACUUM	SOUND LEVEL (db)	INLET / OUTLET NPT
450AB	A14	110	60	60	64	1.50"

PHASE	VOLTAGE	CURRENT	KW	HP	WEIGHT (LBS)
3	220-275/380-480	3.9Δ/2.3Y	0.93	1.25	31

PRESSURE PERFORMANCE CURVE

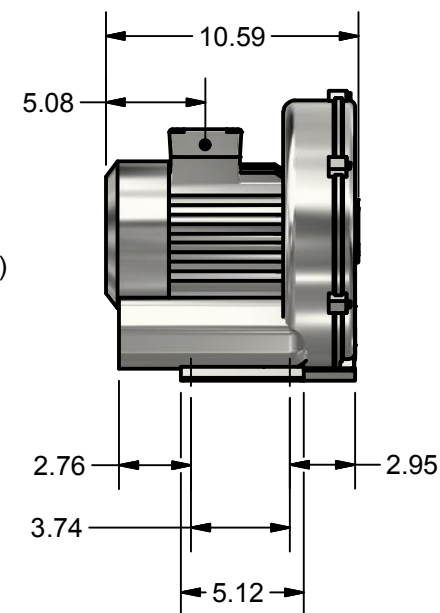
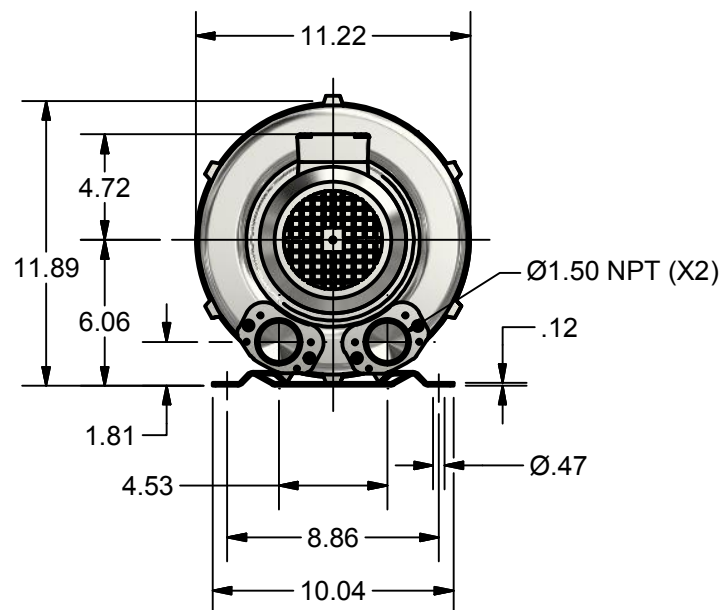
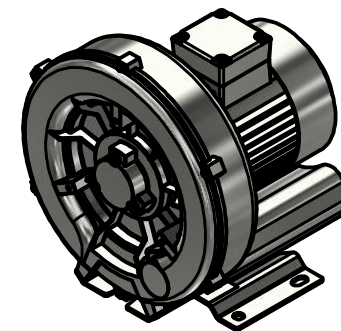
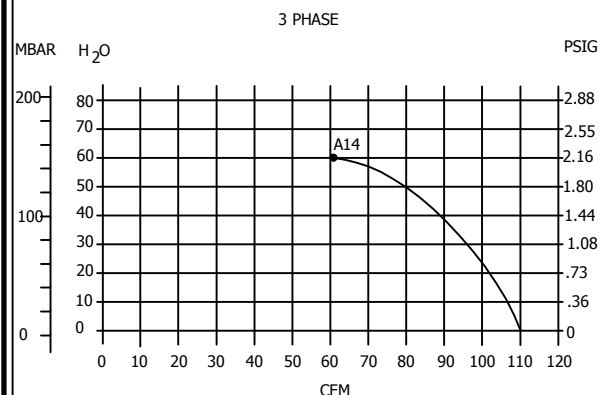

CUSTOMER: \_\_\_\_\_

APPROVED BY: \_\_\_\_\_

DATE: \_\_\_\_\_

ACCESSORIES: \_\_\_\_\_ PART NO. \_\_\_\_\_

FILTER CANISTER: 20222-234

FILTER ELEMENT: 20222-235

SILENCER: 20222-228

ENCLOSED MOTOR STARTER (230V): 20222-250

ENCLOSED MOTOR STARTER (460V): 20222-251

VARIABLE FREQUENCY DRIVE (230V): 20222-252

VARIABLE FREQUENCY DRIVE (460V): 20222-253

NOTES: \_\_\_\_\_

\_\_\_\_\_

SHOWN, PART#20222-221

THESE DRAWINGS AND SPECIFICATIONS  
CONTAIN INFORMATION WHICH  
CONVERTER ACCESSORY CORPORATION  
CONSIDERS PROPRIETARY AND  
CONFIDENTIAL.  
NO PORTION OF THIS DRAWING MAY  
BE REPRODUCED OR COPIED WITHOUT  
PRIOR WRITTEN PERMISSION OF  
CONVERTER ACCESSORY CORPORATION.



CONVERTER ACCESSORY CORP.

WIND GAP, PA 18091

WWW.CONVERTERACCESSORY.COM

TITLE

MODEL#450AB  
REGENERATIVE BLOWER

SIZE

A

DWG NO

18503-277

REV

DATE

DRAWN

FILE

MEMAST

QUOTE NO.