

2

1

3/8-16 SOCKET SET SCREW  
(SPLIT BUSHING LOCKING SCREW)  
SPLIT BUSHING LOCKS TO THRU SHAFT

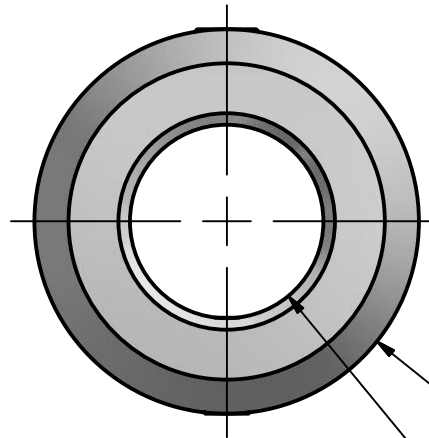
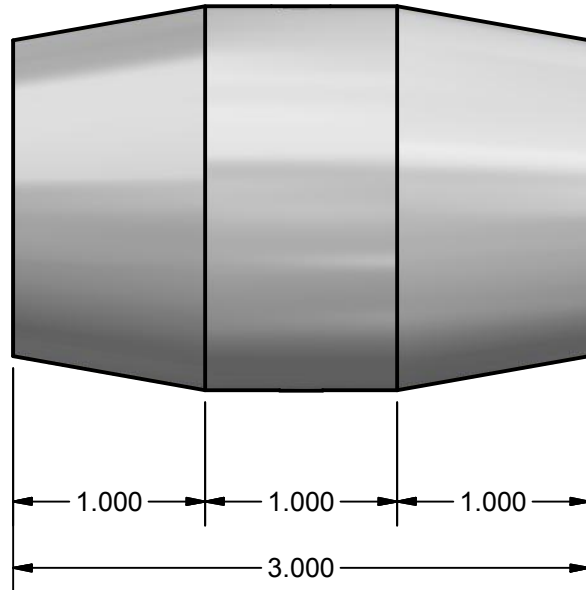
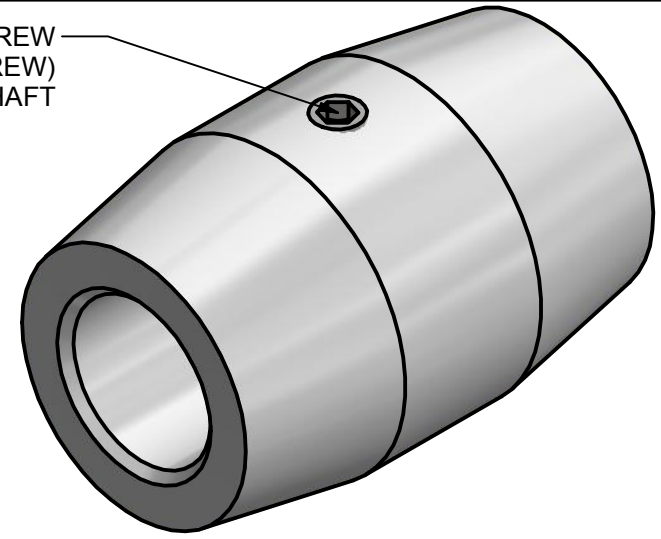

Ø2.000

Ø1.625 MAXIMUM THRU BORE

NOTE:  
THRU BORE MACHINED .010-.015 OVERSIZE  
UNLESS OTHERWISE SPECIFIED.

CUSTOMER: \_\_\_\_\_

APPROVED BY: \_\_\_\_\_

DATE: \_\_\_\_\_

MATERIAL: ☐ ALUMINUM ☐ OTHER \_\_\_\_\_

OPERATING SPECIFICATIONS:

MACHINE: \_\_\_\_\_

MATERIAL: \_\_\_\_\_

THICKNESS: MIN. \_\_\_\_\_ MAX. \_\_\_\_\_

WIDTH: MIN. \_\_\_\_\_ MAX. \_\_\_\_\_

SPEED: MIN. \_\_\_\_\_ MAX. \_\_\_\_\_

TENSION: MIN. \_\_\_\_\_ MAX. \_\_\_\_\_

CORE DIA.: \_\_\_\_\_

CORE MATERIAL: \_\_\_\_\_

MAX. ROLL DIA.: \_\_\_\_\_

MAX. ROLL WEIGHT: \_\_\_\_\_

☐ UNWIND ☐ REWIND☐ SINGLE WIDTH ☐ SLIT WIDTHS☐ ROUND THRU BORE: \_\_\_\_\_☐ SQUARE THRU BORE: \_\_\_\_\_

QUANTITY REQUIRED: \_\_\_\_\_

NOTES: \_\_\_\_\_

THESE DRAWINGS AND SPECIFICATIONS CONTAIN INFORMATION WHICH  
CONVERTER ACCESSORY CORPORATION CONSIDERS PROPRIETARY AND CONFIDENTIAL.  
NO PORTION OF THIS DRAWING MAY BE REPRODUCED OR COPIED WITHOUT PRIOR  
WRITTEN PERMISSION OF CONVERTER ACCESSORY CORPORATION.



CONVERTER ACCESSORY CORP.

WIND GAP, PA 18091

WWW.CONVERTERACCESSORY.COM

TITLE

CENTER PLUG  
FOR 2" CORES

SIZE

A

DWG NO

18503-352

REV

DATE

DRAWN

FILE

MEMAST

QUOTE NO.

2

1