

2

1

B

B

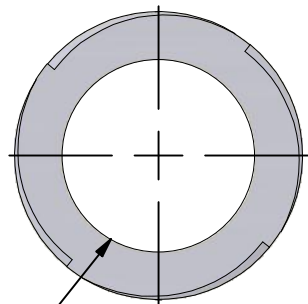

THRU BORE

- ☐ STOCK I.D. SIZE: _____
☐ BEARING BORE ONE END SIZE: _____ DEPTH: _____
☐ BEARING BORE BOTH ENDS SIZE: _____ DEPTH: _____
☐ SNAP RING GROOVE ONE END SIZE: _____
☐ SNAP RING GROOVE BOTH ENDS SIZE: _____
☐ OTHER MACHINING: _____

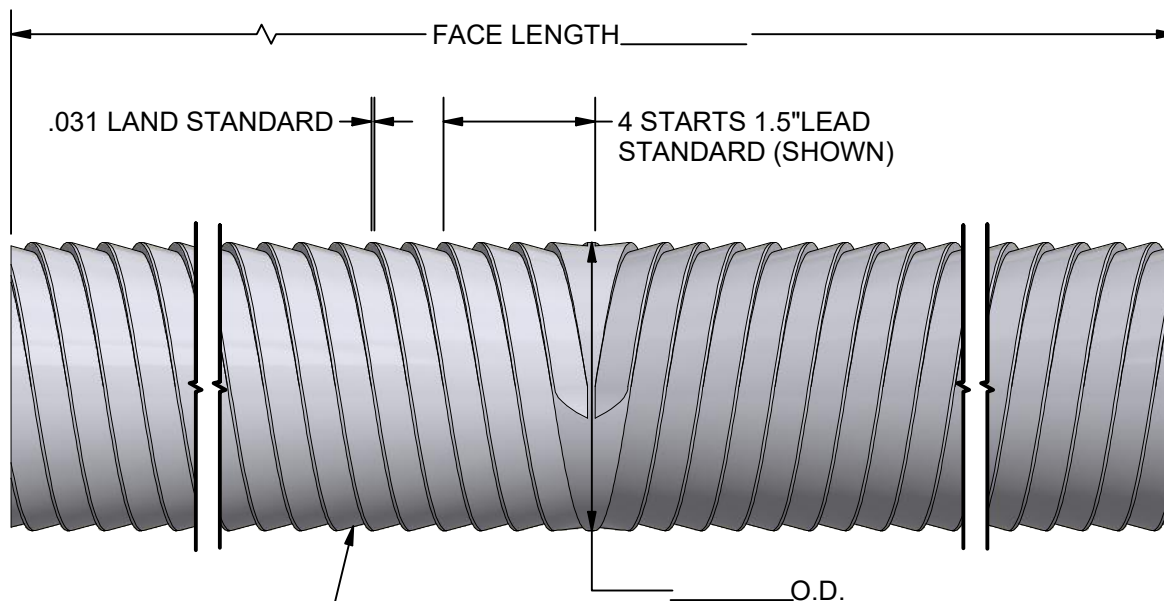

*ROLL FACE COATING:

- ☐ NONE
☐ ANODIZE: _____
☐ PLASMA COATING
☐ TEFLON COATING
☐ OTHER: _____

CUSTOMER: _____

APPROVED BY: _____

DATE: _____

MATERIAL:

- ☐ 6061-T6 ALUMINUM TUBING 1/2" WALL
☐ OTHER: _____

QUANTITY OF ROLLERS REQUIRED: _____

OPERATING SPECIFICATIONS:

MATERIAL: _____
 THICKNESS: MIN. _____ MAX. _____
 WIDTH: MIN. _____ MAX. _____
 SPEED: MIN. _____ MAX. _____
 TENSION: MIN. _____ MAX. _____

*COATING FINISH WILL BE MILL SPEC.

NOTES: _____

THESE DRAWINGS AND SPECIFICATIONS CONTAIN INFORMATION WHICH CONVERTER ACCESSORY CORPORATION CONSIDERS PROPRIETARY AND CONFIDENTIAL. NO PORTION OF THIS DRAWING MAY BE REPRODUCED OR COPIED WITHOUT PRIOR WRITTEN PERMISSION OF CONVERTER ACCESSORY CORPORATION.



CONVERTER ACCESSORY CORP.

WIND GAP, PA 18091
WWW.CONVERTERACCESSORY.COM

TITLE

SCROLL ROLL TUBE

SIZE

A

DWG NO

18503-392

REV

DATE

DRAWN

FILE

MEMAST

QUOTE NO.

2

1

A

A